

KEY PLAN.  
SCALE 1:2500

**DRAWINGS REFERENCES:**

- REFER TO DRAWING A034-CSC-ZZ-XX-DR-C-0015-0016 FOR PROPOSED ROAD LAYOUT
- REFER TO DRAWING A034-CSC-ZZ-XX-DR-C-0017 FOR CROSS SECTION DETAILS AND ROAD BUILD UP DETAILS.
- REFER TO DRAWING A034-CSC-ZZ-XX-DR-C-0020-0021 FOR ROAD MARKINGS AND TRAFFIC SIGNS LAYOUT.

**LEGEND:**

EXISTING GROUND LEVEL ---

PROPOSED GROUND LEVEL ---

RECEIVED: 14/08/2023

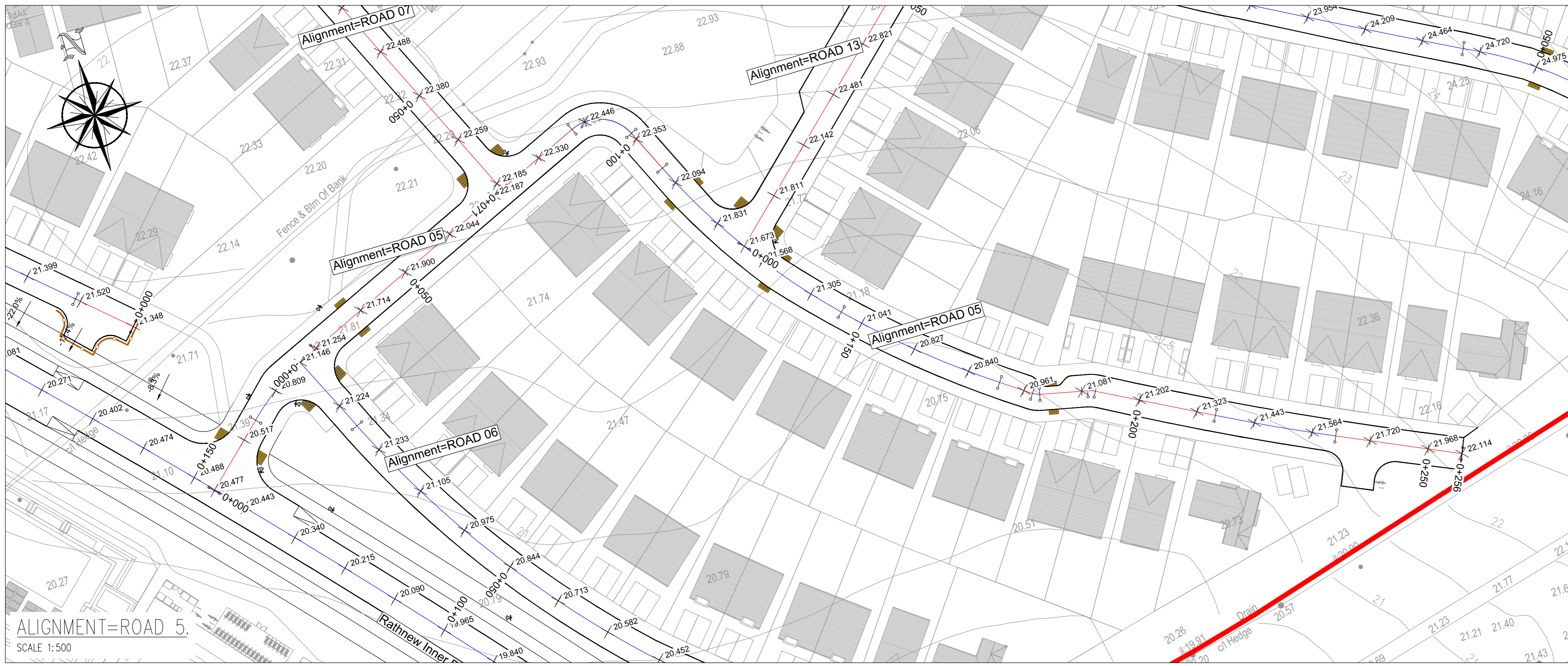

ALIGNMENT=ROAD 5.  
SCALE 1:500

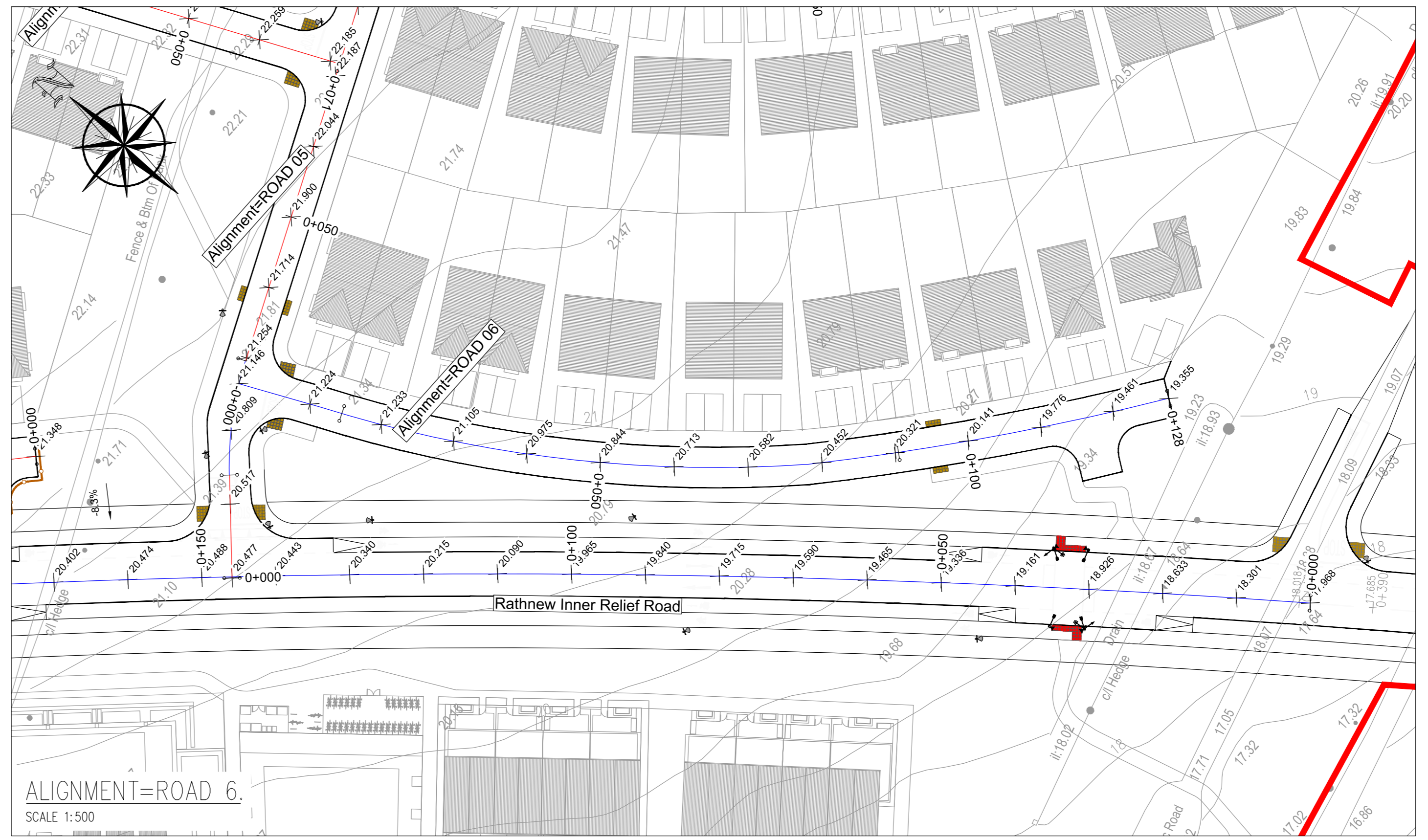

ALIGNMENT=ROAD 6.  
SCALE 1:500

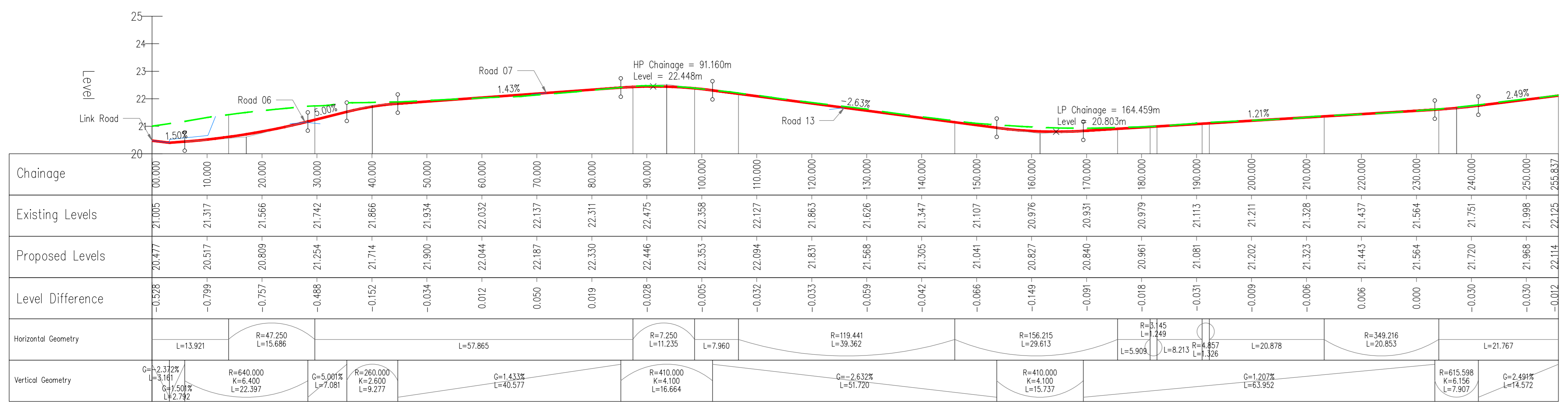

ROAD 05 - LONGSECTION  
SCALE: H 1:500, V 1:100. DATUM: 20.000

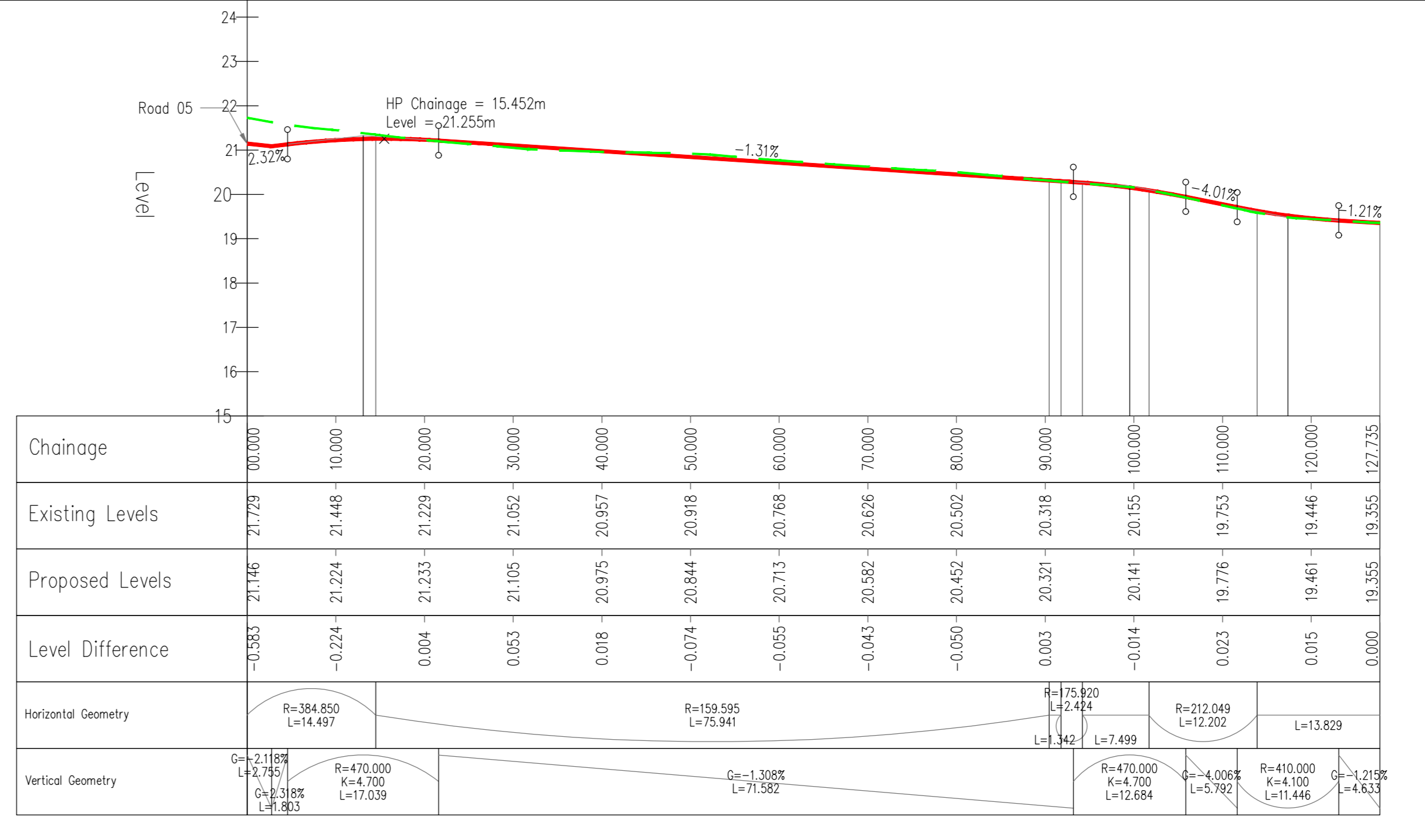

ROAD 06 - LONGSECTION  
SCALE: H 1:500, V 1:100. DATUM: 15.000

**PLANNING DRAWING.**  
NOT FOR CONSTRUCTION.  
ALL LEVELS GIVEN ARE  
RELATIVE TO ORDANCE DATUM.  
THIS DRAWING HAS BEEN ISSUED FOR INFORMATION  
PURPOSES ONLY AND MUST NOT BE USED  
FOR CONSTRUCTION UNDER ANY CIRCUMSTANCES

**NOTES**

- For setting out refer to Architect's drawings.
- This drawing to be read in conjunction with all other Architectural and Engineering drawings and all other relevant drawings and Specifications.
- DO NOT SCALE THIS DRAWING. Use figure dimensions only.
- No part of this document may be reproduced or transmitted in any form or stored in any retrieval system of any nature without the written permission of copyright holder except as agreed.
- For use on the project for which the document was originally issued.
- Ordnance Survey Ireland Licence Number EN 0074023

Rev. No.	Date	REVISION NOTE	Des. By	Chk. By
01	12.12.2022	ISSUED FOR PLANNING	SC	NB
02	16.06.2023	ISSUED FOR PLANNING	SC	NB
03	07.07.2023	ISSUED FOR COORDINATION	SC	NB
04	17.07.2023	LAYOUT UPDATES	SC	NB
05	09.08.2023	ISSUED FOR PLANNING	SC	NB

Client	Keldrum Limited
Project	Large-scale Residential Development at Tinakilly, Wicklow
Title	Road Plan and Profiles Sheet 4 of 8
Dep. No.	A034-CSC-ZZ-XX-DR-C-0029
Date	02 Oct 2023
Scale	AS SHOWN @ A0
Revision	P5

**CS Consulting Group**  
DUBLIN | LONDON | LIMERICK

Head Office  
19-21 Dame Street, Dublin 2.  
T: +353 (0)1 5485063  
E: info@csconsulting.ie  
W: www.csconsulting.ie

Quality ISO 9001:2015  
Environment ISO 14001:2004  
Health & Safety OHSAS 18001:2007